



SPORT TRANSFER
sports equipment

SPORT-TRANSFER sp. z o.o.
Jawornik 564
32-400 Myślenice
Tel. +48 12 649 14 83
e-mail: biuro@sport-transfer.com.pl

INSTRUCTIONS FOR ASSEMBLY AND USE OF SPORTS EQUIPMENT

Product: **Foldable basketball structure**

Code: 10 019 and 10 025

The basketball structure meets the requirements of the PN-EN 913:2019-3 and PN-EN 1270:2006 standard: Playing Field Equipment - Basketball Equipment. Functional And Safety Requirements, Test Methods”.

1. Components

Number	Part/subassembly name	Quantity per product
1	Structure frame	1
2	Structure arms	2
3	Beam fastening the board to the structure	2
4	Diagonal of the structure	1
5	Diagonal lock	1
6	Screw M12x60	8
7	Self-locking nut M12	8
8	Screw M10x45	4
9	Self-locking nut M10	4
10	Washer widened M10	8
11	Pulling handle	2

2. Assembly of the basketball structure

Assembly of the structure must be carried out by a specialist company.

- Attach the frame (1) to the wall in the sports hall at the appropriate height at 13 fixing points.
- It is recommended to select appropriate elements for fixing the structure to the wall, depending on the wall structure.
- Horizontal force acting on a fixed frame equal to $F=900\text{ N}$ or vertical force equal to $F=3200\text{ N}$ should not cause the frame mountings to loosen in the wall.
- Connect the arms (2) to the frame (1) using M12x60 screws (6) and M12 self-locking nuts (7).
- Fix to the arms (2) beams fixing the table to the structure (3) using M12x60 (6) bolts and M12 self-contracting nuts (7).
- Fix the diagonal (4) (as in the picture) in the lower part of the arms (2) using M12x60 bolts (6) and M12 self-locking nuts (7).
- Fix the plate to the beams (3) using M10x45 bolts (8), M10 washers (10) and M10 self-locking nuts (9).
- Position the structure so that the arms (2) are perpendicular to the frame of the structure (1).
- In the diagonal (4) in place of lock (5) make a hole of 10mm diameter for the diagonal lock, the same action should be repeated after folding the structure on the wall.
- Insert the diagonal lock (5).

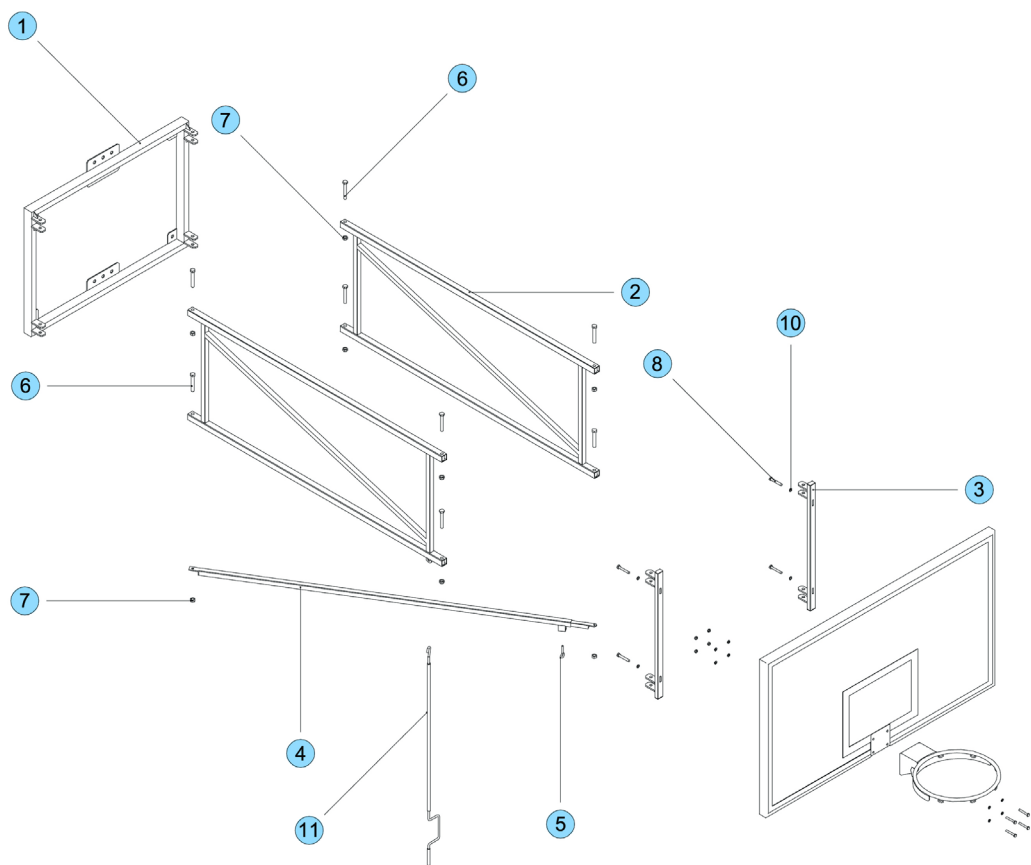

3. Folding in and out of the structure

- Place the first extraction handle (11) on the diagonal lock eye (5) and unlock the mechanism.
- Place the second pulling handle over the eye of the structure arm (2) and fold the structure towards the wall in a steady motion.
- Proceed in the same way when disassembling the structure.

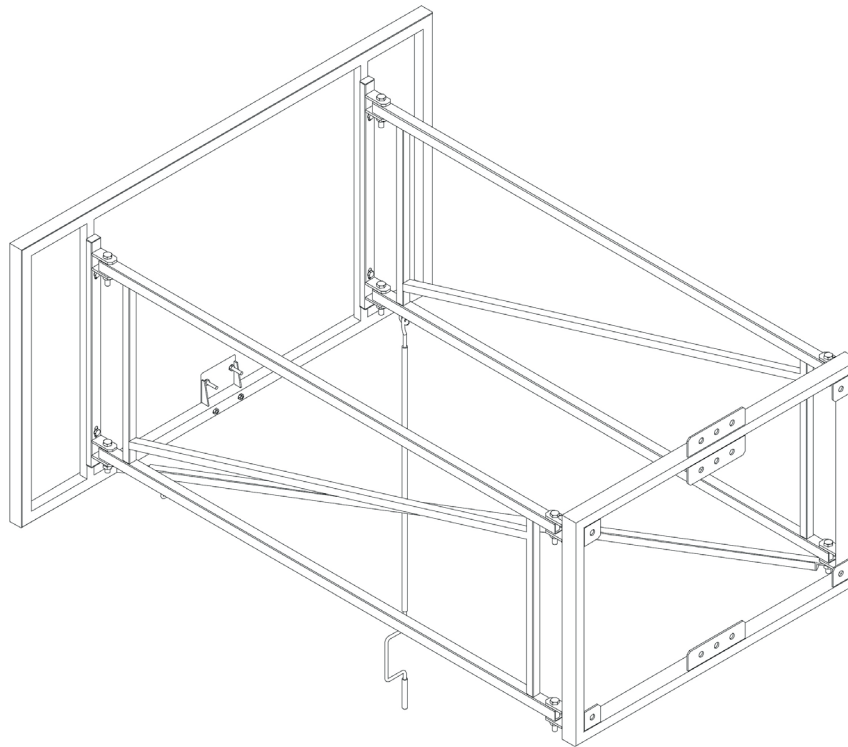

Attention:

Do not fold and unfold the structure pulling the eye of the lock (5)

4. Using the set

- a) The structure is designed exclusively for basketball play and cannot be used for any other purpose.
- b) Before starting to use and periodically (max. every 3 months) it is necessary to check the fastenings of all individual elements of the set.

ATTENTION:

Do not climb or hang on any part of the structure.