



SPORT-TRANSFER sp. z o.o.
Jawornik 564
32-400 Myślenice
Tel. +48 12 649 14 83
e-mail: biuro@sport-transfer.com.pl

INSTRUCTIONS FOR ASSEMBLY AND USE OF SPORTS EQUIPMENT

Product: **Single column basketball set with a 90x120 cm board for outdoor playground**
Code: 10 052, 10 013, 10 007, 10 008

The basketball set meets the requirements of the PN-EN 913:2019-3 and PN-EN 1270:2006 standard:
"Playing Field Equipment - Basketball Equipment. Functional And Safety Requirements, Test Methods".

1. Components

Number	Part/subassembly name	Quantity per product
1	Rack pillar	1
2	Rack boom	1
3	Angle brace	1
4	Epoxy board with metal frame 90x120 cm	1
5	Galvanized rim with chain net	1
6	Steel sleeve	1
7	Locking mechanism	1
8	Screw M12x45 - clamp of the locking mechanism	1
9	Screw M10x70	4
10	Self-locking nut M10	4
11	Screw M8x20 - lock with mushroom head	3
12	Washer fi 8,5	3
13	Screw M12x50	2
14	Nut M12	2
15	Self- locking nut M8	3

2. Installing the basketball set

- Make a foundation in the ground for each sleeve (6).
- Upper edges of the sleeves must be levelled with the playground level.
- Recommended foundation size for both sleeves is min. 800x800 mm and depth min. 1000 mm for concrete class min. C20/25.
- The rack in the sleeve can be installed and operated after the concrete has completely dried out (min. 7 days).
- Mount table (4) and chain net rim (5) on the boom (2) using M10x70 screws (9) and M10 nuts (10).
- Screw the angle brace (3) to the board and the boom using M8x20 (11) screws with washers fi 8.5 (12).

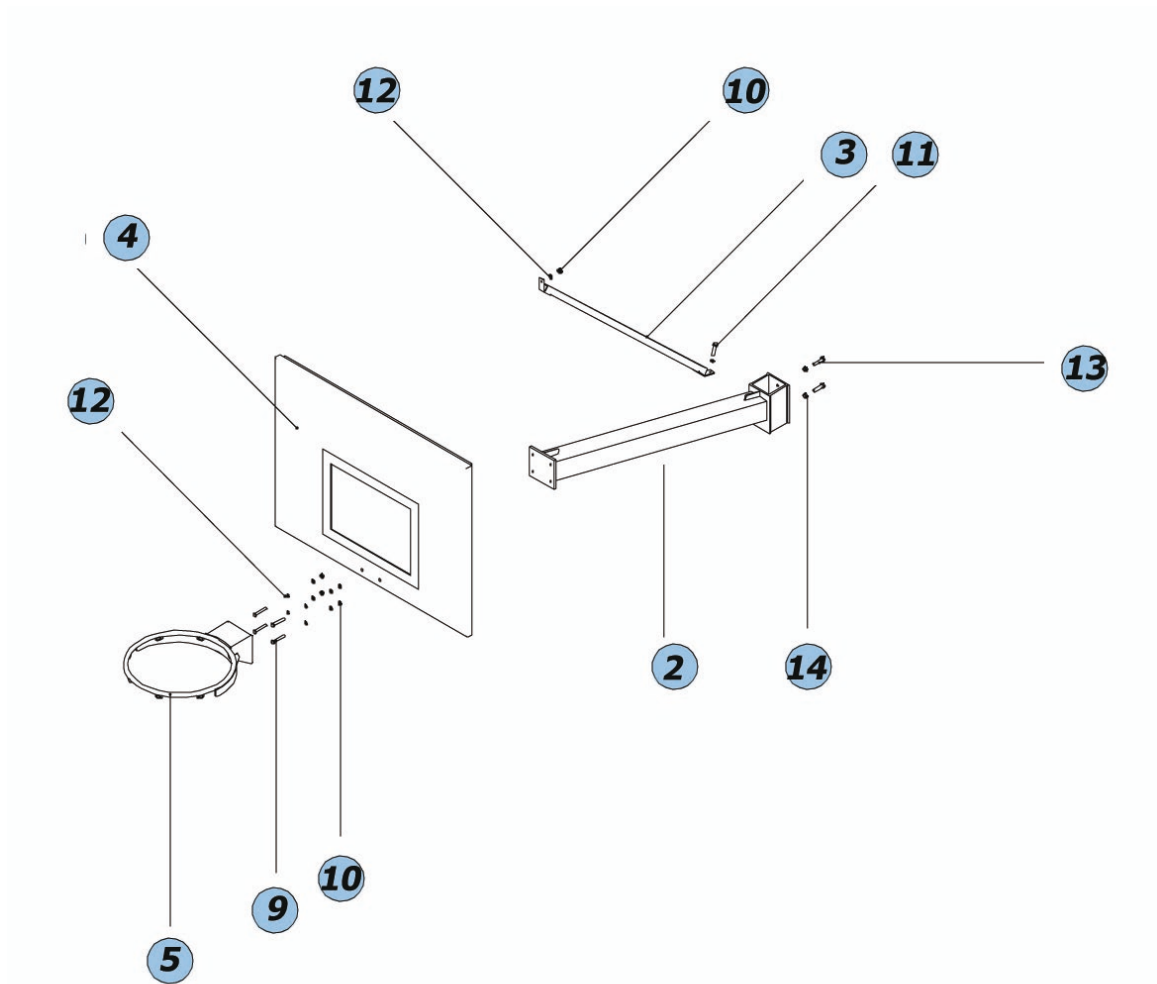

- Insert the rack pillar (1) into the concrete sleeve and by tightening the M12x45 screw (8) with the locking mechanism (7) stabilize the pillar in the sleeve.

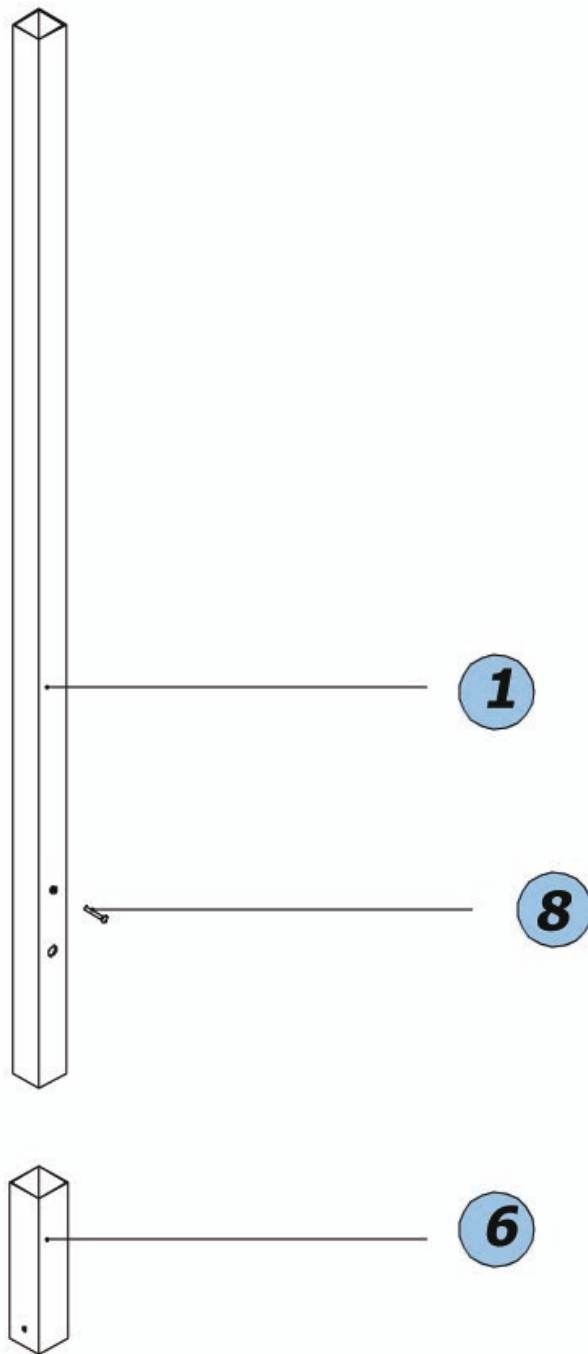

- Slide the pre-assembled table with the boom onto the column, position it at the desired height and lock it onto the pillar using M12x50 bolts (13) and lock it with M12 nuts (14).
- Adjust the position of the angle brace so that the table is vertical.
- Screw the angle brace to the board using M8x20 (11) screws with washers fi 8.5 (12).
- Screw the angle brace (3) to the boom at the specified location using the M8x20 screw (11).

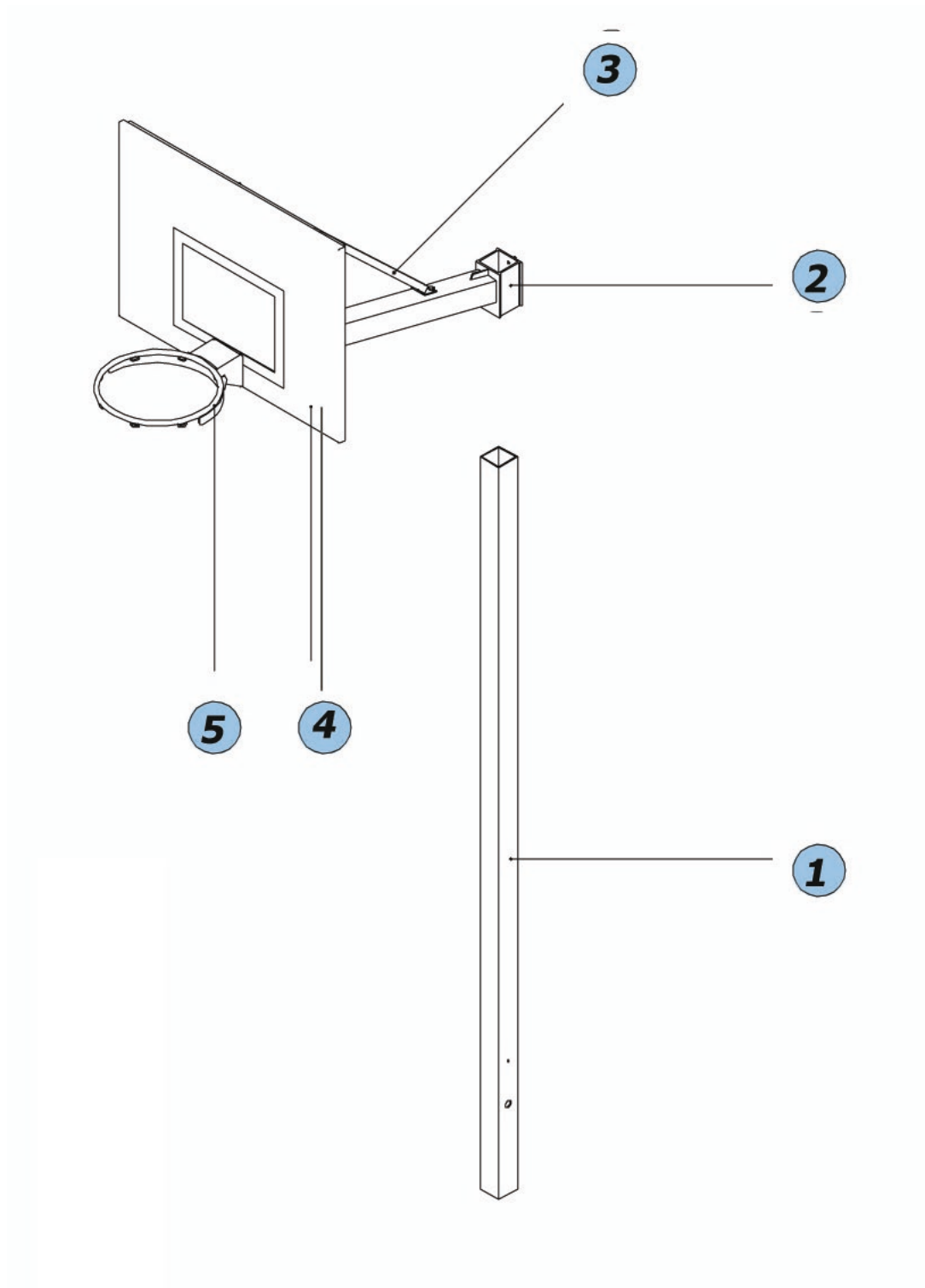

3. Using the set

- a) The set is designed for playing basketball on outdoor playing fields.
- b) Before starting to use and periodically (max. every 3 months) it is necessary to check the fastenings of all individual elements of the set.
- c) The height of the board is adjusted by loosening the nuts (14) and bolts M12x50 (13), shifting the board with the boom on the pole to the desired height and tightening the bolts again and tightening the nuts.

Attention: Only adults (minimum 2 persons) may perform adjustment using the scaffolding.

ATTENTION:

Do not climb or hang on any part of the set.

Do not unscrew the locking mechanism during usage.

